

**XGT** Flexible coupling - High - gain rubber type - Set screw type **NEW**

WEB Selection Tool | WEB CAD Download | Zero Backlash | High gain supported | High torque | Vibration absorption

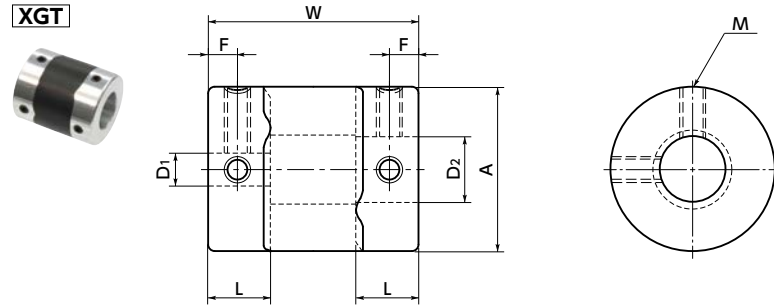

**Dimensions**

Unit : mm

Part Number	A	L	W	F	M	Screw Tightening Torque (N·m)
XGT-15	15	6.5	23	3	M3	0.7
XGT-19	19	7.7	26	4	M3	0.7
XGT-25	25	9.5	32	5	M4	1.7
XGT-27	27	9.5	32	5	M4	1.7
XGT-30	30	11	36	5.5	M4	1.7
XGT-34	34	12	38	6	M5	4
XGT-39	39	15.5	48	8	M5	4
XGT-44	44	15	48	7.5	M6	7
XGT-56	56	19.5	60	10	M6	7

Part Number	Standard bore diameter (dimensional allowance H8)									
	D1-D2									
XGT-15	3-5	3-6	4-4	4-5	4-6	4.5-5	5-5	5-6	6-6	
XGT-19	4-5 6.35-8	4-8 8-8	5-5	5-6	5-7	5-8	6-6	6-6.35	6-7	6-8
XGT-25	5-6 8-10	5-8 8-11	6-6 8-12	6-8 10-10	6-10 10-12	6-11 12-12	6-12	6.35-8	6.35-10	8-8
XGT-27	5-6 8-10	5-8 8-11	5-14 8-12	6-6 8-14	6-8 10-10	6-10 10-12	6-11 10-14	6-12 12-12	6-14 12-14	8-8 14-14
XGT-30	8-8 10-15	8-10 11-12	8-11 12-12	8-12 12-14	8-14 12-15	8-15 14-14	10-10 14-15	10-11 15-15	10-12	10-14
XGT-34	8-8 10-15	8-10 11-11	8-11 11-12	8-12 12-12	8-14 12-14	8-15 12-15	10-10 14-14	10-11 14-15	10-12 15-15	10-14 16-16
XGT-39	10-10 12-20	10-12 14-14	10-14 14-15	10-15 14-16	10-16 15-15	12-12 15-16	12-14 15-19	12-15 16-16	12-16 17-17	12-19 20-20
XGT-44	12-12 15-19	12-14 15-20	12-16 16-16	12-19 16-19	14-14 17-17	14-15 19-20	14-16 20-20	14-19	15-15	15-16
XGT-56	15-15	15-19	15-20	15-25	19-20	19-24	20-20	20-25	24-25	25-25

- All products are provided with hex socket set screw.
- In a case where the bore diameter is  $\phi 4$  or less, the setscrew is used in only one place.
- Recommended dimensional allowances of applicable shaft diameter are h6 and h7.

**Performance**

Part Number	Max. Bore Diameter (mm)	Rated*1 torque (N·m)	Max.*1 torque (N·m)	Max. Rotational Frequency (min <sup>-1</sup> )	Moment*2 of Inertia (kg·m <sup>2</sup> )	Static Torsional Stiffness (N·m/rad)	Max. Lateral Misalignment (mm)	Max. Angular Misalignment (°)	Max. Axial Misalignment (mm)	Mass*2 (g)
XGT-15	6	1.1	2.2	42000	$2.6 \times 10^{-7}$	43	0.15	1.5	$\pm 0.2$	9
XGT-19	8	2.1	4.2	33000	$7.5 \times 10^{-7}$	88	0.15	1.5	$\pm 0.2$	15
XGT-25	12	4	8	25000	$2.7 \times 10^{-6}$	140	0.15	1.5	$\pm 0.2$	29
XGT-27	14	4	8	23000	$3.6 \times 10^{-6}$	140	0.15	1.5	$\pm 0.2$	32
XGT-30	15	6.3	12.6	21000	$6.3 \times 10^{-6}$	220	0.2	1.5	$\pm 0.3$	46
XGT-34	16	8	16	18000	$1.1 \times 10^{-5}$	390	0.2	1.5	$\pm 0.3$	66
XGT-39	20	13.5	27	16000	$2.4 \times 10^{-5}$	520	0.2	1.5	$\pm 0.3$	103
XGT-44	22	18	36	14000	$4.0 \times 10^{-5}$	640	0.2	1.5	$\pm 0.3$	133
XGT-56	28	35	70	11000	$1.3 \times 10^{-4}$	1500	0.2	1.5	$\pm 0.3$	267

\*1 Correction of rated torque and max. torque due to load fluctuation is not required. However, if ambient temperature exceeds 30°C, be sure to correct the rated torque and max. torque with temperature correction factor shown in the following table. XGT's allowable operating temperature is -20°C to 80°C.

\*2 These are values with max. bore diameter.

• Ambient Temperature / Temperature Correction Factor

Ambient Temperature	Temperature Correction Factor
-20°C to 30°C	1.00
30°C to 40°C	0.80
40°C to 60°C	0.70
60°C to 80°C	0.55

• Part number specification

**XGT-39-12-20**

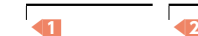

Additional Keyway at Shaft Hole → P.xxxx | Cleanroom Wash & Packaging → P.xxxx | Change to Stainless Steel Screw → P.xxxx  
Available / Add'l charge | Available / Add'l charge | Available / Add'l charge