

MSX-C Flexible coupling - Slit - type - Clamping type

[WEB Selection Tool](#)
[WEB CAD Download](#)
[Zero Backlash](#)
[High Rigidity](#)

MSX-C Made of aluminum alloy

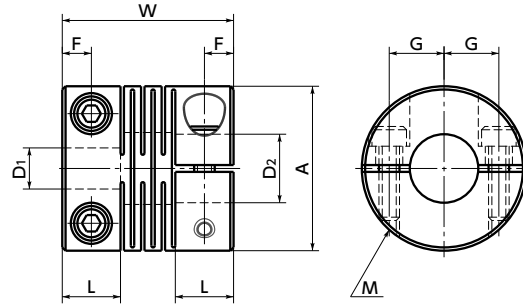

Dimensions

Unit : mm

Part Number	A	L	W	F	G	M	Screw Tightening Torque (N·m)
MSX-16C	16	6	17.4	3	4.74	M2	0.5
MSX-19C	19	6.8	20	3.4	5.6	M2.5	1
MSX-24C	24	8.5	25	4.25	8	M3	1.5
MSX-29C	29	10.2	30	5.1	9	M3	1.5
MSX-34C	34	12	35	6	11	M3	1.5
MSX-39C	39	13.5	40	6.75	14	M4	2.5
MSX-44C	44	15.5	45	7.75	16	M4	2.5

Part Number	Standard Bore Diameter D1-D2							
MSX-16C	5 - 5	5 - 6	6 - 6					
MSX-19C	5 - 5 6.35 - 6.35	5 - 6 6.35 - 8	5 - 7 8 - 8	5 - 8	6 - 6	6 - 6.35	6 - 7	6 - 8
MSX-24C	6 - 6 8 - 9.525	6 - 8 8 - 10	6 - 10 9.525 - 10	6.35 - 6.35 10 - 10	6.35 - 8	6.35 - 10	7 - 8	8 - 8
MSX-29C	8 - 8 12 - 12	8 - 10	8 - 11	8 - 12	10 - 10	10 - 11	10 - 12	11 - 12
MSX-34C	10 - 14 15 - 15	11 - 14 15 - 16	12 - 12 16 - 16	12 - 14	12 - 16	14 - 14	14 - 15	14 - 16
MSX-39C	10 - 14 15 - 15	12 - 12 15 - 16	12 - 14 16 - 16	12 - 15	12 - 16	12 - 19	14 - 14	14 - 15
MSX-44C	12 - 12 15 - 19	12 - 14 15 - 20	12 - 19 20 - 20	14 - 14	14 - 15	14 - 16	15 - 15	15 - 16

- All products are provided with hex socket head cap screw.
- Recommended dimensional allowances of applicable shaft diameter are h6 and h7.
- In case of mounting on D-cut shaft, be careful about the position of the D-cut surface of the shaft. ➔ P.257

Performance

Part Number	Max. Bore Diameter (mm)	Rated*1 torque (N·m)	Max.*1 torque (N·m)	Max. Rotational Frequency (min ⁻¹)	Moment*2 of Inertia (kg·m ²)	Static Torsional Stiffness (N·m/rad)	Max. Lateral Misalignment (mm)	Max. Angular Misalignment (°)	Max. Axial Misalignment (mm)	Mass*2 (g)
MSX-16C	6	0.5	1	39000	2.5×10 ⁻⁷	200	0.05	0.5	±0.1	7
MSX-19C	8	1	2	33000	5.8×10 ⁻⁷	270	0.05	0.5	±0.1	12
MSX-24C	10	1.5	3	26000	1.8×10 ⁻⁶	790	0.05	0.5	±0.1	23
MSX-29C	12	2	4	21000	4.7×10 ⁻⁶	1400	0.05	0.5	±0.1	41
MSX-34C	16	3	6	18000	1.1×10 ⁻⁵	2200	0.05	0.5	±0.1	62
MSX-39C	20	6	12	16000	2.3×10 ⁻⁵	4100	0.05	0.5	±0.1	88
MSX-44C	22	9	18	14000	4.3×10 ⁻⁵	5100	0.05	0.5	±0.1	128

*1 Correction of rated torque and max. torque due to load fluctuation is not required.

*2 These are values with max. bore diameter.

• Part number specification

MSX-39C - 14-15

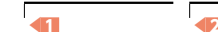

[Additional Keyway at Shaft Hole ➔ P.788](#)
[Cleanroom Wash & Packaging ➔ P.792](#)
[Change to Stainless Steel Screw ➔ P.790](#)