

# MLR-C/MLRS-C Rigid coupling - Clamping type

[WEB Selection Tool](#)
[WEB CAD Download](#)
[Zero Backlash](#)
[High Rigidity](#)
[SUS Stainless steel](#)

**MLR-C** Made of aluminum alloy  
**MLRS-C** Made of all stainless steel

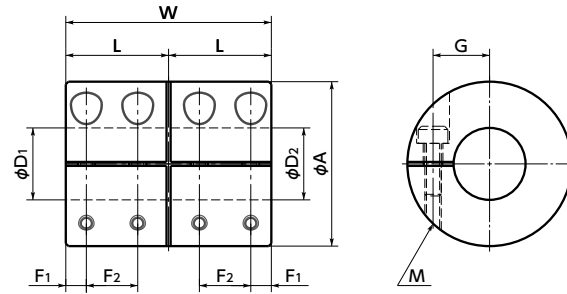

## Dimensions

Unit : mm

Part Number	A	L	W	F1	F2	G	M	Screw Tightening Torque (N·m)	Standard Bore Diameter D1-D2								
									5 - 5	5 - 6	6 - 6	6 - 8	8 - 8	8 - 10	10 - 10	10 - 12	12 - 12
<b>MLR-16C</b>	16	11	22	2.5	5.5	5	M2	0.5	5 - 5	5 - 6	6 - 6						
<b>MLR-20C</b>	20	12	24	2.5	6	7	M2	0.5	6 - 6	6 - 8	8 - 8						
<b>MLR-25C</b>	25	18	36	4.5	9	9	M2.5	1	8 - 8	8 - 10	10 - 10	12 - 12					
<b>MLR-32C</b>	32	20	40	4	10	11	M3	1.5	10 - 10	10 - 12	10 - 14	12 - 12	12 - 14	14 - 14	15 - 15		
<b>MLRS-16C</b>	16	11	22	2.5	5.5	5	M2	0.5	5 - 5	5 - 6	6 - 6						
<b>MLRS-20C</b>	20	12	24	2.5	6	7	M2	0.5	6 - 6	6 - 8	8 - 8						
<b>MLRS-25C</b>	25	18	36	4.5	9	9	M2.5	1	8 - 8	8 - 10	10 - 10	12 - 12					
<b>MLRS-32C</b>	32	20	40	4	10	11	M3	1.5	10 - 10	10 - 12	10 - 14	12 - 12	12 - 14	14 - 14	15 - 15		

- All products are provided with hex socket head cap screws.
- Recommended dimensional allowances of applicable shaft diameter are h6 and h7.
- In case of mounting on D-cut shaft, be careful about the position of the D-cut surface of the shaft. → P.257

## Performance

Part Number	Max. Bore Diameter (mm)	Rated torque*1 (N·m)	Max. torque*1 (N·m)	Max. Rotational Frequency (min <sup>-1</sup> )	Moment of Inertia*2 (kg·m <sup>2</sup> )	Mass*2 (g)
<b>MLR-16C</b>	6	1	2	39000	3.4×10 <sup>-7</sup>	10
<b>MLR-20C</b>	8	2.5	5	31000	9.2×10 <sup>-7</sup>	18
<b>MLR-25C</b>	12	4.5	9	25000	3.4×10 <sup>-6</sup>	38
<b>MLR-32C</b>	15	10	20	19000	1.0×10 <sup>-5</sup>	70
<b>MLRS-16C</b>	6	0.3	0.6	39000	8.9×10 <sup>-7</sup>	25
<b>MLRS-20C</b>	8	0.5	1	31000	2.5×10 <sup>-6</sup>	45
<b>MLRS-25C</b>	12	1	2	25000	9.2×10 <sup>-6</sup>	100
<b>MLRS-32C</b>	15	2	4	19000	2.7×10 <sup>-5</sup>	180

- \*1 Correction of rated torque and max. torque due to load fluctuation is not required.
- \*2 These are values with max. bore diameter.

[Additional Keyway at Shaft Hole → P.788](#)
[Cleanroom Wash & Packaging → P.792](#)
[SUS Change to Stainless Steel Screw → P.790](#)

Please feel free to contact us

Available / Add'l charge

Available / Add'l charge

• Part number specification

**MLR-16C-5-5**

1

2