

MOHS-C Cleanroom / Vacuum / Heat Resistant Coupling - Oldham - Type (VESPEL®) - Clamping Type

[WEB Selection Tool](#)
[WEB CAD Download](#)
[Cleanroom](#)
[Electrical Insulation](#)
[Heat-resistance](#)
[Chemical-proof](#)
[High Allowable Misalignment](#)

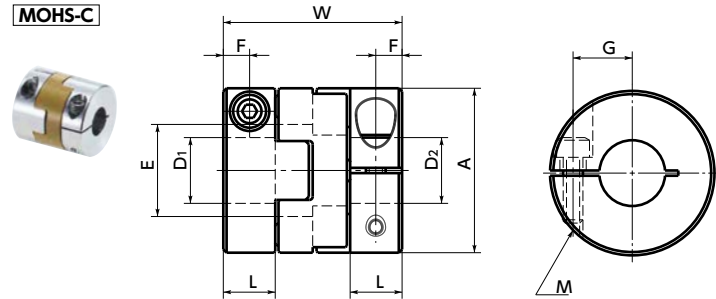

Dimensions

Unit : mm

Part Number ¹	A	L	W	E	F	G	M	Screw Tightening Torque (N·m)
MOHS-19C	19	7	22.1	10	3.5	6.5	M2.5	0.5
MOHS-26C	25.4	8	27.2	14	4	9	M3	0.7
MOHS-32C	31.7	10	33.3	18	5	11	M4	1.2

Part Number	Standard Bore Diameter D1 · D2 ²						
	5	6	8	10	11	12	14
MOHS-19C	●	●	●				
MOHS-26C			●	●			
MOHS-32C			●	●	●	●	●

- All products are provided with hex socket head cap screw.
- Recommended dimensional allowances of applicable shaft diameter are h6 and h7.
- In case of mounting on D-cut shaft, be careful about the position of the D-cut surface of the shaft. → P.257

Performance

Part Number	Max. Bore Diameter (mm)	Rated*1 torque (N·m)	Max.*1 torque (N·m)	Max. Rotational Frequency (min ⁻¹)	Moment*2 of Inertia (kg·m ²)	Static Torsional Stiffness (N·m/rad)	Max. Lateral Misalignment (mm)	Max. Angular Misalignment (°)	Mass*2 (g)
MOHS-19C	8	0.4	0.8	900	1.4×10 ⁻⁶	160	1.3	2	28
MOHS-26C	10	1.2	2.4	900	5.5×10 ⁻⁶	220	1.5	2	61
MOHS-32C	14	2.2	4.4	900	1.6×10 ⁻⁵	600	2	2	110

- *1 Correction of rated torque and max. torque due to load fluctuation is not required.
- *2 These are values with max. bore diameter.

[Additional Keyway at Shaft Hole → P.788](#)
[Cleanroom Wash & Packaging → P.792](#)
[Change to Stainless Steel Screw → P.790](#)
 Available / Add'l charge Cleanroom washed and packed Changed to the S.S. screw

- Part number specification

MOHS-32C-10-12 1 set



MOHS-SPCR Single Spacer

