

SCAP-PT/SNCPS Cover Caps - PTFE (Teflon) / Socket Head Cap Screws for Cover Caps

[WEB Selection Tool](#)
[WEB CAD Download](#)
[Cleanroom wash & packaging](#)
[Chemical-proof](#)
[SUS Stainless steel](#)

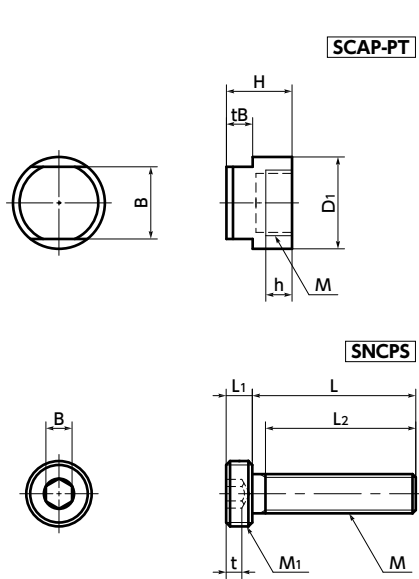

- Combine **SCAP-PT** Cover Caps and **SNCPS** Socket Head Cap Screws for Cover Caps.
- The PTFE (Teflon) cover protects the screw head from corrosion caused by chemicals.
- PTFE is a plastic with excellent chemical resistance, and most chemicals cannot penetrate it.
- Chemical Resistance of PTFE → P.657
- Since the screw portion is stainless steel, they can be used with higher tightening forces than PTFE screws.
- Tightening with the recommendation torque has a sealing effect and the bearing surface of the cover cap fits the attachment surface tightly. Airtight testing at 0.6 MPa confirmed that there is no leakage.
- Also, make cover caps from requested materials such as Hastelloy* and PEEK are available.
*Hastelloy is a registered trademark of Haynes International, Inc.
- Application
FPD production equipment, semiconductor fabrication wet processes, printed circuit board etching devices, metallic surface treatment equipment and facilities, cleaning equipment, and chemical plants

	SCAP-PT Cover Caps	SNCPS Socket Head Cap Screws
Main Body	PTFE (Tetrafluoroethylene : Teflon*)	SUSXM7 (S.S. grade : A2)
Strength Class		A2-50

*Teflon is a registered trademark of DuPont.

SCAP-PT Cover Caps										
Part Number	M	H	D1	h	B	tB	Recommendation Torque (N·m)	SNCPS Part.No	Mass (g)	Qty per pack
SCAP-3-PT	M5×0.5	6	9	2	7	3	0.04	SNCPS-M3	0.65	1
SCAP-4-PT	M6×0.75	8	10	2.8	8	3	0.08	SNCPS-M4	1.1	1
SCAP-5-PT	M8×0.75	9	12	3.5	9	3	0.2	SNCPS-M5	1.6	1
SCAP-6-PT	M10×0.75	10	14	4	11	4	0.35	SNCPS-M6	2.3	1
SCAP-8-PT	M12×1	11	16	5	13	4	0.45	SNCPS-M8	3.1	1
SCAP-10-PT	M16×1	12	20	6	17	4	0.6	SNCPS-M10	4.8	1

- Usage
After tightening **SNCPS** Socket Head Cap Screw for Cover Cap, attach **SCAP-PT** Cover Cap so that it covers the head of **SNCPS**.
Ensure that the tightening torque of **SCAP-PT** does not exceed the recommendation torque in the chart.

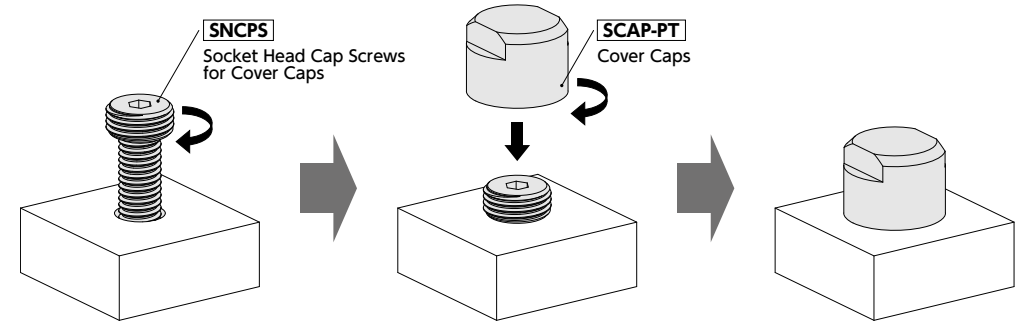

● Related Products

SCAP-AL aluminum alloy for use in vacuum chambers are available.
→ P.582



SCAP-CE ceramic cover cap for use in vacuum chambers are available.
→ P.582



● Part number specification

SCAP-6-PT **SCAP-PT** Cover Caps

1

SNCPS-M6-20 **SNCPS** Socket Head Cap Screws for Cover Caps

2

3

Order **SCAP-PT** and **SNCPS** individually.

SNCPS Socket Head Cap Screws for Cover Caps

Unit : mm

Part Number	M	L								M1	L1	B	t	L2*1	SCAP-PT Part.No	Mass (g)
SNCPS-M3	M3	6	8	10	12					M5×0.5	2	2	1.5	Full Thread	SCAP-3	0.53 - 0.78
SNCPS-M4	M4		8	10	12	16				M6×0.75	2.8	2.5	2.3	Full Thread	SCAP-4	1.3 - 1.9
SNCPS-M5	M5			10	12	16	20			M8×0.75	3.5	3	2.7	Full Thread	SCAP-5	2 - 3.3
SNCPS-M6	M6				12	16	20	25		M10×0.75	4	4	3	Full Thread	SCAP-6	3.8 - 6.4
SNCPS-M8	M8					16	20	25	30	M12×1	5	5	3.8	22(L=35)	SCAP-8	9 - 16
SNCPS-M10	M10						20	25	30	M16×1	6	6	4.5	26(L=40)	SCAP-10	17 - 27

*1 If the "L" value is other than the value in parentheses, the screw is full thread.

Part Number	Qty per pack
SNCPS-M3	1
SNCPS-M4	1
SNCPS-M5	1
SNCPS-M6	1
SNCPS-M8	1
SNCPS-M10	1

[1 Individual Sales → P.794](#)
[Cleanroom Wash & Packaging → P.792](#)
[Screw Length Adjustment → P.796](#)
[Vibration Resistant → P.795](#)
[Modification process for captive use → P.791](#)
 1 pc. in 1 bag Cleanroom washed and packed S.S. only/ Add'l charge S.S. only/ Add'l charge Not Available