

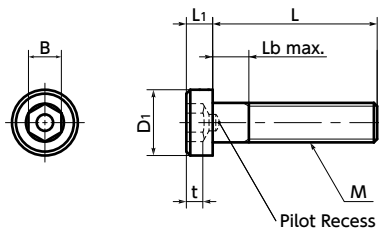

# SLP Socket Head Cap Screws with Low Profile with Pilot Recess

WEB Selection Tool   
 WEB CAD Download   
 Protrusion



- Part number specification

## SLP-M6-20

1 2

Order in number of packs.

The minimum order quantity is 1 piece. → P.794

- These socket head cap screws have low head heights.
- Intended for reducing the size of devices and applications with limited overhead space.
- Install and remove by using **SKP** Specialty Key. As the pilot recess guides securely, you can tighten at higher torque more safely. (Commercially available hex keys can also be used for tightening.)

- Application

Reducing the size of equipment and devices

- Material/Finish

RoHS Compliant

	SLP
Main Body	Equivalent to S45C Ferrosferic Oxide Coating (Black)
Strength Class	8.8

Unit : mm

Part Number	M	L					D1	L1	B	t	Lb	Max. Torque (N·m)	Mass (g)
SLP-M4	M4	8	10				7	2.8	3	1.6	3.5	2	1.3 - 1.4
SLP-M5	M5		10	12	16	20	8.5	3.5	4	2	4.2	6	2 - 3.3
SLP-M6	M6		10	12	16	20	10	4	5	2.5	5.5	9	3.5 - 5.3
SLP-M8	M8			12	16	20	13	5	6	3	7	20	7.8 - 10

Part Number	Qty*1 per pack
SLP-M4	20
SLP-M5	20
SLP-M6	20
SLP-M8	20

\*1 The minimum order quantity is 1 piece. → P.794

- Dedicated wrench

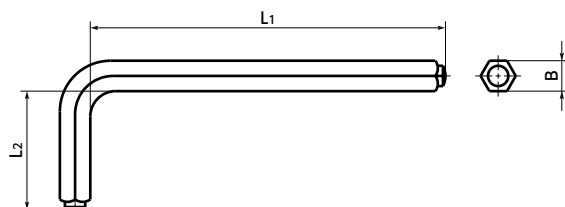

Part Number	B Nominal of Key	L1	L2	with Screw	Mass (g)	Qty per pack
SKP-3	3	63	20	SLP-M4	5	1
SKP-4	4	71	25	SLP-M5	10	1
SKP-5	5	80	28	SLP-M6	28	1
SKP-6	6	90	32	SLP-M8	34	1

Individual Sales → P.794   
 Cleanroom Wash & Packaging → P.792   
 Screw Length Adjustment → P.796   
 Vibration Resistant → P.795   
 Modification process for captive use → P.791

Available / Add'l charge    Available / Add'l charge    Available / Add'l charge    Available / Add'l charge    Please feel free to contact us