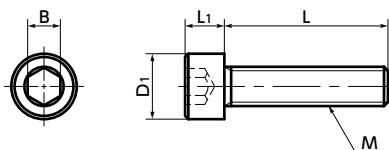

# SNSH-C22 Socket Head Cap Screw - Hastelloy\*C-22 equiv.

[WEB Selection Tool](#)
[WEB CAD Download](#)
[Cleanroom wash & packaging](#)
[Chemical-proof](#)

## ● Mechanical property

	Hastelloy C-22	SUS304
Tensile Strength (N/mm <sup>2</sup> )	786	520 or Higher
0.2% Proof Stress (N/mm <sup>2</sup> )	365	205 or Higher
Elongation (%)	57	40 or Higher
Hardness (HRB)	92	90 or Less

● Values in chart are for reference only. They are not guaranteed values.

## ● Physical property

	Hastelloy C-22	SUS304
Specific Gravity	8.61	7.93
Longitudinal Elastic Modulus (GPa)	209	193
Specific Heat (J/kg · K)	381	500
Electric Resistance (μΩ · m)	1.2	0.7
Linear Expansion Coefficient (K <sup>-1</sup> )	12.4 × 10 <sup>-6</sup>	17.3 × 10 <sup>-6</sup>

● Values in chart are for reference only. They are not guaranteed values.

- Hastelloy C-22 is one of the few metals that is resistant to wet chlorine gas, hypochlorite, and chlorine dioxide.
- Excellent corrosion resistance against oxidizing and reducing acids and salts. ➔ P.637
- For aquatic applications that use sea and salt water.
- Application

FPD production equipment, semiconductor devices, printed circuit board etching devices, metallic surface treatment equipment and facilities, and chemical plants

## ● Material/Finish

	SNSH-C22
Main Body	UNS N06022(Hastelloy*C-22 equiv.)

\*Hastelloy is a registered trademark of Haynes International, Inc.

Unit : mm

Part Number	M	L									D1	L1	B	Tension*1 Rupture Load (N)	Mass (g)
		6	8	10	12	16	20	25	30	35					
<b>SNSH-M3-C22</b>	M3	6	8	10	12	16	20				5.5	3	2.5	3950	0.79 - 1.5
<b>SNSH-M4-C22</b>	M4		8	10	12	16	20	25			7	4	3	6900	1.8 - 3.5
<b>SNSH-M5-C22</b>	M5			10	12	16	20	25			8.5	5	4	11100	3 - 5.3
<b>SNSH-M6-C22</b>	M6				12	16	20	25	30		10	6	5	15700	5.6 - 9.2
<b>SNSH-M8-C22</b>	M8					16	20	25	30	35	13	8	6	28700	13 - 21

\*1 Values in chart are for reference only. They are not guaranteed values.

Part Number	Qty per pack
<b>SNSH-M3-C22</b>	1
<b>SNSH-M4-C22</b>	1
<b>SNSH-M5-C22</b>	1
<b>SNSH-M6-C22</b>	1
<b>SNSH-M8-C22</b>	1

## ● Part number specification

### SNSH - M5 - 16 - C22

Product Code	1	2	Product Code
--------------	---	---	--------------

<a href="#">1 Individual Sales</a> ➔ P.794	<a href="#">Cleanroom Wash &amp; Packaging</a> ➔ P.792	<a href="#">Screw Length Adjustment</a> ➔ P.796	<a href="#">Vibration Resistant</a> ➔ P.795	<a href="#">Modification process for captive use</a> ➔ P.791
1 unit in 1 bag	Cleanroom washed and packed	Available / Add'l charge	Available / Add'l charge	Available / Add'l charge