

# SNSH-C276 Socket Head Cap Screw - Hastelloy\*C-276 equiv.

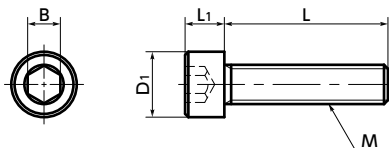

[WEB Selection Tool](#)
[WEB CAD Download](#)
[Cleanroom wash & packaging](#)
[Chemical-proof](#)



## ● Mechanical property

	HastelloyC-276	SUS304
Tensile Strength (N/mm <sup>2</sup> )	793	520 or Higher
0.2% Proof Stress (N/mm <sup>2</sup> )	400	205 or Higher
Elongation (%)	60	40 or Higher

● Values in chart are for reference only. They are not guaranteed values.

## ● Physical property

	HastelloyC-276	SUS304
Specific Gravity	8.89	7.93
Longitudinal Elastic Modulus (GPa)	205	193
Specific Heat (J/kg·K)	427	500
Electric Resistance (μΩ·m)	1.3	0.7
Linear Expansion Coefficient (K <sup>-1</sup> )	11.2×10 <sup>-6</sup>	17.3×10 <sup>-6</sup>

● Values in chart are for reference only. They are not guaranteed values.



- Hastelloy C-276 is a general type of Hastelloy.
- Excellent corrosion resistance against oxidizing and reducing salts. → P.637
- Also, **SNSH-C22** Socket Head Screw - Hastelloy (Hastelloy C-22), which is also resistant to wet chlorine gas, hypochlorite, and chlorine dioxide is available. → P.645
- Application

FPD production equipment, semiconductor devices, printed circuit board etching devices, metallic surface treatment equipment and facilities, and chemical plants

## ● Material/Finish

RoHS Compliant

	SNSH-C276
Main Body	UNS N10276(Hastelloy*C-276 equiv.)

\*Hastelloy is a registered trademark of Haynes International, Inc.

Unit : mm

Part Number	M									D1	L1	B	Tension*1 Rupture Load (N)	Mass (g)
	1	L												
<b>SNSH-M3-C276</b>	M3	6	8	10	12	16	20			5.5	3	2.5	3980	0.81 - 1.6
<b>SNSH-M4-C276</b>	M4		8	10	12	16	20	25		7	4	3	6960	1.9 - 3.6
<b>SNSH-M5-C276</b>	M5			10	12	16	20	25		8.5	5	4	11200	3.1 - 5.4
<b>SNSH-M6-C276</b>	M6				12	16	20	25	30	10	6	5	15900	5.8 - 9.5
<b>SNSH-M8-C276</b>	M8					16	20	25	30	35	13	8	29000	14 - 22

\*1 Values in chart are for reference only. They are not guaranteed values.

Part Number	Qty per pack
<b>SNSH-M3-C276</b>	1
<b>SNSH-M4-C276</b>	1
<b>SNSH-M5-C276</b>	1
<b>SNSH-M6-C276</b>	1
<b>SNSH-M8-C276</b>	1

## ● Part number specification

### SNSH - M5 - 16 - C276

Product Code **1** **2** Product Code

[1 Individual Sales → P.794](#)
[Cleanroom Wash & Packaging → P.792](#)
[Screw Length Adjustment → P.796](#)
[Vibration Resistant → P.795](#)
[Modification process for captive use → P.791](#)

1 unit in 1 bag

Cleanroom washed and packed

Available / Add'l charge

Available / Add'l charge

Available / Add'l charge