



SNSIV Socket Head Cap Screws - Super Invar

WEB Selection Tool

WEB CAD Download

Cleanroom wash & packaging

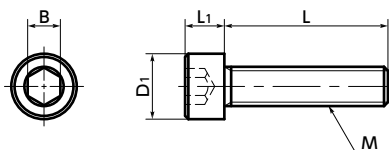

● Mechanical property

| | Super Invar | SUS304 |
|--|-------------|---------------|
| Tensile Strength (N/mm ²) | 470 | 520 or Higher |
| 0.2% Proof Stress (N/mm ²) | 333 | 205 or Higher |
| Elongation (%) | 43 | 40 or Higher |
| Hardness (HV) | 143 | 200 or Less |

● Values in chart are for reference only. They are not guaranteed values.

● Physical property

| | Super Invar | SUS304 |
|---|-----------------------|-----------------------|
| Specific Gravity | 8.15 | 7.93 |
| Longitudinal Elastic Modulus (GPa) | 132 | 193 |
| Electric Resistance ($\mu\Omega \cdot m$) | 0.77 | 0.7 |
| Thermal Conductivity (W/(m·K)) | 10.47 | 17 |
| Linear Expansion Coefficient (K ⁻¹) | 0.69×10^{-6} | 17.3×10^{-6} |

● Values in chart are for reference only. They are not guaranteed values.

- Super Invar is a special alloy with an extremely low linear expansion coefficient, and its dimensions change very little due to temperature.
- For measurement and precision instruments which do not allow changes in dimensions due to thermal expansion.
- For Prevention from loosening and damage due to differences in thermal expansion.
- Linear Expansion Coefficient:
 $0.69 \times 10^{-6} (K^{-1})$ (30 deg C - 100 deg C)

● Application

Precision and measurement instruments

● Material/Finish

RoHS Compliant

| SNSIV | |
|-----------|-------------|
| Main Body | Super Invar |

Unit : mm

| Part Number 1 | M | L 2 | | | | | | | | D1 | L1 | B | Tension*1 Rupture Load (N) | Mass (g) |
|------------------|----|-----|---|----|----|----|----|----|----|-----|----|-----|-------------------------------|------------|
| SNSIV-M3 | M3 | 6 | 8 | 10 | 12 | 16 | 20 | | | 5.5 | 3 | 2.5 | 2360 | 0.74 - 1.4 |
| SNSIV-M4 | M4 | | 8 | 10 | 12 | 16 | 20 | 25 | | 7 | 4 | 3 | 4120 | 1.7 - 3.3 |
| SNSIV-M5 | M5 | | | 10 | 12 | 16 | 20 | 25 | | 8.5 | 5 | 4 | 6670 | 2.8 - 5 |
| SNSIV-M6 | M6 | | | | 12 | 16 | 20 | 25 | 30 | 10 | 6 | 5 | 9440 | 5.3 - 8.7 |
| SNSIV-M8 | M8 | | | | | 16 | 20 | 25 | 30 | 35 | 13 | 8 | 17200 | 13 - 20 |

*1 Values in chart are for reference only. They are not guaranteed values.

| Part Number | Qty per pack |
|-----------------|--------------|
| SNSIV-M3 | 1 |
| SNSIV-M4 | 1 |
| SNSIV-M5 | 1 |
| SNSIV-M6 | 1 |
| SNSIV-M8 | 1 |

● Part number specification

SNSIV-M5 - 16



| | | | | |
|----------------------------|------------------------------------|---------------------------------|-----------------------------|--|
| 1 Individual Sales → P.794 | Cleanroom Wash & Packaging → P.792 | Screw Length Adjustment → P.796 | Vibration Resistant → P.795 | Modification process for captive use → P.791 |
| 1 unit in 1 bag | Cleanroom washed and packed | Available / Add'l charge | Available / Add'l charge | Available / Add'l charge |