

SPA-LC Plastic screw - Hex Socket Low Head Bolt - RENY **NEW**



WEB Selection Tool

WEB CAD Download

High strength

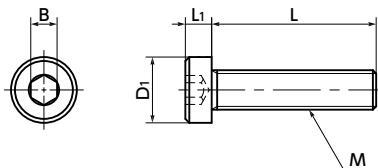

● Material/Finish

RoHS Compliant

	SPA-LC
Main body	RENY* (Glass Fiber 50% Reinforced Polyamide MXD6) (Black)
Heat resistance temperature**	105°C

*RENY is a registered trademark of Mitsubishi Engineering-Plastics Corporation.

**A value of plastic materials. The allowable operating temperature of the product varies depending on use conditions such as tightening torque.

- Hex socket head cap screw with low head.
- For space-saving of equipment/device and applications with a limited top space.
- RENY is thermoplastic engineering plastics with excellent tensile strength and bending strength.
- It is highly fatigue-resistant and has excellent creeping and heat insulation properties.
- While it is nearly as strong as metal, its weight is approximately 1/5 of iron.
- Plastic screw properties and precautions for use
➔ P.724

● Application

Heat insulation and dew condensation prevention of electric and electronic devices / refrigerating and freezing facilities / Weight saving of offshore instruments, plating facility and automobile, aircraft and space equipment, etc.

Unit : mm

Part Number	M	L								D1	L1	B	Tension*1 Rupture Load (N)	Torsional*1 Torque (N·m)	Mass (g)
SPA-M3-LC	M3	6	8	10	12	16	20			5.5	2	2	740	0.31	0.11 - 0.25
SPA-M4-LC	M4	6	8	10	12	16	20			7	2.8	2.5	1325	0.62	0.24 - 0.48
SPA-M5-LC	M5			10	12	16	20	25	30	8.5	3.5	3	2050	1.20	0.43 - 1.0
SPA-M6-LC	M6					16	20	25	30	40	10	4	2798	2.15	0.96 - 2.1

*1 Values in chart are for reference only. They are not guaranteed values. The recommendation torque is 50% of the torsional torque.

Part Number	Qty per pack*1
SPA-M3-LC	20
SPA-M4-LC	20
SPA-M5-LC	20
SPA-M6-LC	20

*1 The minimum order quantity is 1 piece. ➔ P.794

● Part number specification

SPA - M5 - 30 - LC

Product Code **1** **2** Product Code

Order in number of packs.
The minimum order quantity is 1 piece. ➔ P.794

Individual Sales ➔ P.794	Cleanroom Wash & Packaging ➔ P.792	Screw Length Adjustment ➔ P.796	Vibration Resistant ➔ P.795	Modification process for captive use ➔ P.791
Available / Add'l charge	Available / Add'l charge	Not Available	Not Available	Not Available