

SSC (INCH) Socket Head Cap Captive Screws (Inch Screws) NEW

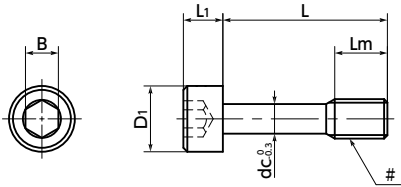

WEB Selection Tool WEB CAD Download **SUS** Stainless steel



- Installation example
Machine a screw hole on the cover and let through the threaded part of **SSC(INCH)**. Threaded part of **SSC(INCH)** is still engaged with the screw hole on the cover even after the screw is removed from the frame, so **SSC(INCH)** never fall out of the cover.

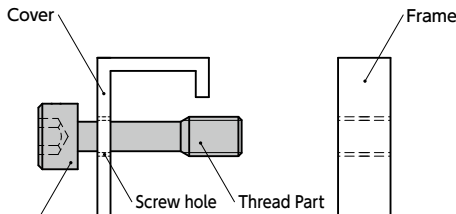

SSC(INCH) Socket Head Cap Captive Screw (Inch Screws)

- Part number specification

SSC-#4-40-5/8



- It prevents fall-off and missing of the screw. For fixing of protection cover and cover for inspection that are frequently mounted and removed.
- Inch screw type.
- For CE marking. → P.681
- Use a dedicated wrench **SKH(INCH)** for mounting and removal. → P.703
- We also produce captive screws of special specifications, e.g. dimensions, shapes, materials and surface treatment. Please feel free to contact our customer service.



- Application

Fixing of protection cover and cover for inspection / CE marking
Machine tool / Food machinery / and Electronic device

- Material/Finish



| | SSC (INCH) |
|--------------------------|----------------------|
| Main body | Equivalent to SUS304 |
| Tensile strength ranking | A2-50 |

- ⚠️ Precautions for Use

- Screw hole inner diameter on the cover side shall be at least the dc dimension.
- The cover thickness should be 0.8 mm or above.

Unit : Inch

| Part Number | # Nominal of Thread | L | | | | | | | Lm(mm) | D1 | L1 | B | dc(mm) | Mass(g) | |
|-------------------|---------------------|------|-----|-----|-----|-----|-----|---|--------|-------|-------|------|--------|-------------|-----------|
| SSC-#4-40 | No.4-40UNC | 5/16 | 3/8 | 1/2 | 5/8 | | | | 4 | 0.183 | 0.112 | 3/32 | 1.9 | 0.63 - 0.94 | |
| SSC-#6-32 | No.6-32UNC | | 3/8 | 1/2 | 5/8 | 3/4 | | | 5 | 0.226 | 0.138 | 7/64 | 2.4 | 1.2 - 1.7 | |
| SSC-#8-32 | No.8-32UNC | | 3/8 | 1/2 | 5/8 | 3/4 | | | 5 | 0.27 | 0.164 | 9/64 | 3 | 1.8 - 2.7 | |
| SSC-#10-32 | No.10-32UNF | | 3/8 | 1/2 | 5/8 | 3/4 | 7/8 | | 6 | 0.312 | 0.19 | 5/32 | 3.7 | 2.7 - 4.2 | |
| SSC-1/4-20 | 1/4-20UNC | | | | 5/8 | 3/4 | 7/8 | 1 | 1 1/4 | 9 | 0.375 | 0.25 | 3/16 | 4.6 | 6.2 - 9.3 |

| Part Number | Qty per pack |
|-------------------|--------------|
| SSC-#4-40 | 1 |
| SSC-#6-32 | 1 |
| SSC-#8-32 | 1 |
| SSC-#10-32 | 1 |
| SSC-1/4-20 | 1 |

| | | | | |
|-----------------------------------|---|--|--------------------------------------|---|
| 1 Individual Sales → P.794 | 1 Cleanroom Wash & Packaging → P.792 | 1 Screw Length Adjustment → P.796 | 1 Vibration Resistant → P.795 | 1 Modification process for captive use → P.791 |
| 1 unit in 1 bag | Available / Add'l charge | Not Available | Not Available | with Captive Processing |