

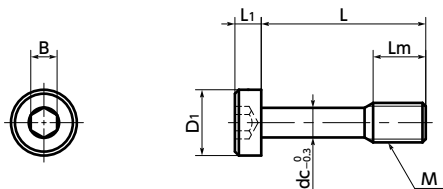

SSCLS Socket Head Cap Captive Screws with Low Profile

Selection Tool
 CAD Download
 Protrusion
 SUS Stainless steel



⚠ Precautions for Use

- The inner diameter of the screw hole of the cover must be equal or larger than dimension d.
- The thickness of the cover must be 0.8 mm or more.
- Installation example
Make a screw hole in the cover, then pass **SSCLS** thread through it. Even when the screw is removed from the frame, **SSCLS** does not fall out from the cover because **SSCLS** thread catches on the screw hole of the cover.

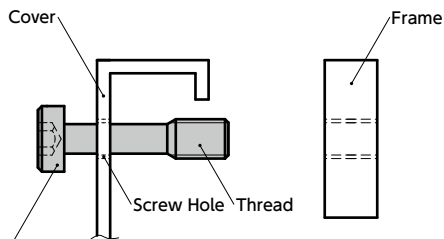

SSCLS Socket Head Cap Captive Screw with Low Profile

- The shape of the screws prevent them from falling out and being lost. They are intended to fix protective and inspection covers that are frequently installed and removed.
- These screws are intended for the reduction of the size of machinery and device and applications with limited overhead space.
- These items comply with CE marking requirements. → P.681

• Application

Securement of protective and inspection covers and compliance with CE marked products
Machine tools, food industry machines, and electrical and electronic equipment

• Material/Finish

RoHS Compliant

	SSCLS
Main Body	SUSXM7 (S.S. grade : A2)
Strength Class	A2-50

Unit : mm

Part Number	M	L								Lm	D1	L1	B	dc	Mass (g)
SSCLS-M3	M3	8	10	12	16					4	5.5	2	2	2.2	0.62 - 0.98
SSCLS-M4	M4		10	12	16	20				5	7	2.8	2.5	3	1.4 - 2.3
SSCLS-M5	M5			12	16	20	25			6	8.5	3.5	3	3.9	2.3 - 4.1
SSCLS-M6	M6			12	16	20	25	30		8	10	4	4	4.5	3.8 - 7.1
SSCLS-M8	M8				16	20	25	30	35	40	10	13	5	6.3	9 - 18

Part Number	Qty per pack
SSCLS-M3	1
SSCLS-M4	1
SSCLS-M5	1
SSCLS-M6	1
SSCLS-M8	1

• Part number specification

SSCLS-M6-12

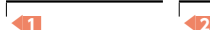

Individual Sales → P.794	Cleanroom Wash & Packaging → P.792	Screw Length Adjustment → P.796	Vibration Resistant → P.795	Modification process for captive use → P.791
1 unit in 1 bag	Available / Add'l charge	Not Available	Not Available	with Captive Processing