

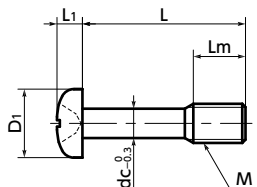

SSCPS Cross Recessed Pan Head Captive Machine Screws

WEB Selection Tool WEB CAD Download SUS Stainless steel



● Installation example

Make a screw hole in the cover, then pass **SSCPS** thread through it. Even when the screw is removed from the frame, **SSCPS** does not fall out from the cover because **SSCPS** thread catches on the screw hole of the cover.

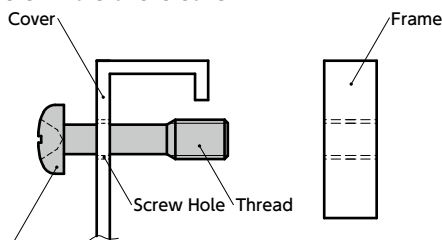

SSCPS Cross Recessed Pan Head Captive Machine Screw

- The shape of the screws prevent them from falling out and being lost. They are intended to fix protective and inspection covers that are frequently installed and removed.
- Cross Recessed pan head machine screws.
- These items comply with CE marking requirements.
 - ➔ P.681
- Application

Securement of protective and inspection covers and compliance with CE marked products.
Machine tools, food industry machines, and electrical and electronic equipment

● Material/Finish



	SSCPS
Main Body	SUSXM7 (S.S. grade : A2)
Strength Class	A2-50

⚠ Precautions for Use

- The inner diameter of the screw hole of the cover must be equal or larger than dimension d.
- The thickness of the cover must be 0.8 mm or more.

Unit : mm

Part Number	M	L								Lm	D1	L1	dc	Mass (g)
SSCPS-M3	M3	8	10	12	16					4	5.5	2	2.2	0.61 - 0.94
SSCPS-M4	M4		10	12	16	20				5	7	2.6	3	1.3 - 2.1
SSCPS-M5	M5			12	16	20	25			6	9	3.3	3.9	2.7 - 4.2
SSCPS-M6	M6			12	16	20	25	30		8	10.5	3.9	4.6	4.3 - 7.4
SSCPS-M8	M8				16	20	25	30	35	40	10	14	5.2	10 - 18

Part Number	Qty per pack
SSCPS-M3	1
SSCPS-M4	1
SSCPS-M5	1
SSCPS-M6	1
SSCPS-M8	1

● Part number specification

SSCPS-M6-12



1 Individual Sales ➔ P.794	Cleanroom Wash & Packaging ➔ P.792	Screw Length Adjustment ➔ P.796	Vibration Resistant ➔ P.795	Modification process for captive use ➔ P.791
1 unit in 1 bag	Available / Add'l charge	Not Available	Not Available	with Captive Processing