

SWAS-AW Adjust Washer - Stainless Steel NEW

WEB Selection Tool | WEB CAD Download | SUS Stainless steel

SWAS-AWBK

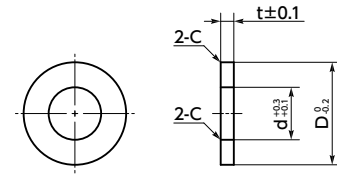

*D=16 or less : C0.2 or less
D=20 or more : C0.5 or less

- There is a variety of outside diameters and thickness relative to normal plain washers.
- For securing seating surface on the long hole position and engagement of materials with low marginal seating surface pressure such as aluminum and resin.
- For adjustment of cumulative error in assembly.

• Application

Height adjustment / Seating surface fall prevention

• Material/Finish



	SWAS-AW
Main body	SUS304

Unit : mm

Part Number	d ◀1	D ◀2	t ◀3					Mass (g)	Qty per pack*1
			1	1.5	2	3	5		
SWAS-2-8-AW	2	8	●		●			0.38 - 0.75	10
SWAS-3-8-AW	3	8	●		●			0.35 - 0.69	10
SWAS-4-8-AW	4	8	●	●	●			0.3 - 0.6	10
SWAS-4-10-AW	4	10	●		●	●		0.53 - 1.6	10
SWAS-4-12-AW	4	12	●		●	●		0.8 - 2.4	10
SWAS-4-15-AW	4	15			●	●		2.6 - 3.9	10
SWAS-5-8-AW	5	8	●	●	●			0.25 - 0.49	10
SWAS-5-10-AW	5	10	●		●	●		0.47 - 1.4	10
SWAS-5-12-AW	5	12	●		●	●		0.74 - 2.2	10
SWAS-5-15-AW	5	15			●	●		2.5 - 3.7	10
SWAS-5-16-AW	5	16			●	●		2.9 - 4.3	10
SWAS-5-20-AW	5	20	●		●			2.3 - 4.7	10
SWAS-6-10-AW	6	10	●		●	●		0.4 - 1.2	10
SWAS-6-12-AW	6	12	●		●	●		0.68 - 2	10
SWAS-6-15-AW	6	15			●	●		2.4 - 3.5	10
SWAS-6-16-AW	6	16			●	●	●	2.7 - 6.8	10
SWAS-6-20-AW	6	20	●		●	●	●	2.3 - 11	10
SWAS-6-25-AW	6	25			●	●	●	7.3 - 18	10

*1 The minimum order quantity is 1 piece. → P.794

Unit : mm

Part Number	d ◀1	D ◀2	t ◀3					Mass (g)	Qty per pack*1
			1	1.5	2	3	5		
SWAS-8-12-AW	8	12			●	●	●	1 - 2.5	10
SWAS-8-16-AW	8	16			●	●	●	2.4 - 6	10
SWAS-8-20-AW	8	20			●	●	●	4.2 - 10	10
SWAS-8-25-AW	8	25			●	●	●	7 - 17	10
SWAS-8-30-AW	8	30			●	●	●	10 - 26	10
SWAS-10-12-AW	10	12			●	●	●	0.55 - 1.4	10
SWAS-10-16-AW	10	16				●	●	2.9 - 4.8	10
SWAS-10-20-AW	10	20			●	●	●	3.7 - 9.3	10
SWAS-10-25-AW	10	25				●	●	9.8 - 16	10
SWAS-10-30-AW	10	30				●	●	15 - 25	10
SWAS-12-16-AW	12	16				●	●	2.1 - 3.5	10
SWAS-12-20-AW	12	20			●	●	●	3.2 - 8	10
SWAS-12-25-AW	12	25				●	●	9 - 15	10
SWAS-12-30-AW	12	30				●	●	14 - 23	10
SWAS-16-20-AW	16	20			●	●	●	1.8 - 4.5	10
SWAS-16-25-AW	16	25				●	●	6.9 - 11	10
SWAS-16-30-AW	16	30				●	●	12 - 20	10

*1 The minimum order quantity is 1 piece. → P.794

Individual Sales → P.794 | Cleanroom Wash & Packaging → P.792 | Screw Length Adjustment → P.796 | Vibration Resistant → P.795 | Modification process for captive use → P.791

Available / Add'l charge | Available / Add'l charge | Not Available | Not Available | Not Available

• Part number specification

SWAS-2-8-1-AW

Product Code ◀1 ◀2 ◀3 Product Code

Select the t dimension from the dimension list.