

XUT-C Flexible coupling - Cross joint - type - Clamping type

[WEB Selection Tool](#)
[WEB CAD Download](#)
[High Rigidity](#)
[Vibration absorption](#)

XUT-C

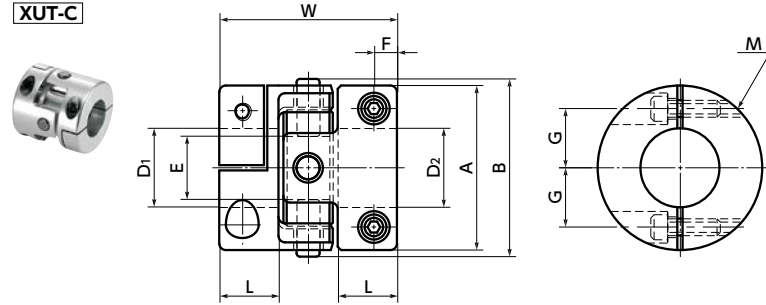

Dimensions

Unit : mm

Part Number	A	B	L	W	E	F	G	M	Screw Tightening Torque (N·m)
XUT-15C	15	16	6	18	4	2.5	5.2	M2	0.5
XUT-20C	20	22	7	20	7	2.7	6.5	M2	0.5
XUT-25C	25	27	9	27	10	3.5	9	M2.5	1
XUT-30C	30	32	9.5	30	10	4	10.5	M3	1.5
XUT-35C	35	37	11.5	35	13	5	12.5	M4	2.5
XUT-40C	40	42	12.5	40	15	5.5	15	M4	2.5

Part Number	Standard Bore Diameter D1・D2													
	3	4	5	6	8	10	11	12	14	15	16	18	19	20
XUT-15C	●	●	●	●										
XUT-20C		●	●	●	●									
XUT-25C			●	●	●	●	●	●						
XUT-30C				●	●	●	●	●	●					
XUT-35C					●	●	●	●	●	●				
XUT-40C					●	●	●	●	●	●	●	●	●	●

- All products are provided with hex socket head cap screw.
- Recommended dimensional allowances of applicable shaft diameter are h6 and h7.
- In case of mounting on D-cut shaft, be careful about the position of the D-cut surface of the shaft. → P.257

Performance

Part Number	Max. Bore Diameter (mm)	Rated*1 torque (N·m)	Max.*1 torque (N·m)	Max. Rotational Frequency (min ⁻¹)	Moment*2 of Inertia (kg·m ²)	Static Torsional Stiffness (N·m/rad)	Max. Lateral Misalignment (mm)	Max. Angular Misalignment (°)	Mass*2 (g)
XUT-15C	6	0.3	0.6	42000	2.3×10 ⁻⁷	200	0.2	1	8
XUT-20C	8	0.6	1.2	31000	8.1×10 ⁻⁷	400	0.2	1	16
XUT-25C	12	1.2	2.4	25000	2.7×10 ⁻⁶	900	0.2	1	33
XUT-30C	14	2.4	4.8	21000	6.2×10 ⁻⁶	1300	0.2	1	53
XUT-35C	16	4	8	18000	1.3×10 ⁻⁵	2200	0.2	1	81
XUT-40C	20	6	12	15000	2.6×10 ⁻⁵	2300	0.2	1	120

*1 Correction of rated torque and max. torque due to load fluctuation is not required.

*2 These are values with max. bore diameter.

- Part number specification

XUT-30C-10-12

1

2

[Additional Keyway at Shaft Hole → P.788](#)
[Cleanroom Wash & Packaging → P.792](#)
[Change to Stainless Steel Screw → P.790](#)
 Available / Add'l charge Please feel free to contact us Available / Add'l charge