

# ZD(ZB) Series Long Stroke Slide

## High Rigidity and Light Weight via Large Size Hollow Guide Rod

### Key Features

■ **Position confirmation switch can be mounted (option)**

LED non-contact switch for large load open & close capacity

■ **Absorbers are optional**

Absorber cushions for high speed applications

■ **Rail slots for wires and pipes**

Multiple cables & pipes can be lined in the rail slot

■ **Front and back stroke adjustment as standard**

Adjustable stroke bolt for fine adjustment at the front and back end

■ **Front and back stroke adjustment**

Adjustable Stroke at front end via back plate with bands

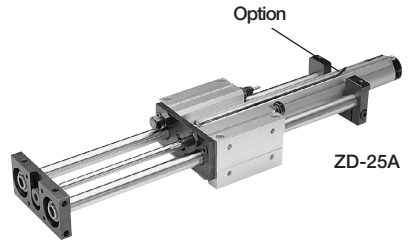

### How To Order

Standard ----- **ZD- 25A**

Option ----- **ZD - 25A - 75 - ET3S2 - F**

ZC-25A (75mm Stroke) with 2 of ET3 non-contact reed switches, that has 2 of absorbers

Model	
Symbol	Name
ZD	Bearing Type
ZB	Bush Type

Size
Symbol
25A
32A
40A
50A

Stroke			
Symbol	Specification	Symbol	Specification
75	75mm	600	600mm
100	100mm	700	700mm
150	150mm	800	800mm
200	200mm	900	900mm
250	250mm	1000	1000mm
300	300mm		
350	350mm		
400	400mm		
450	450mm		
500	500mm		

Sensor, Quantity	
Symbol	Name
ET3	Non-Contact 3-Lead
ET3L	Non-Contact 3-Lead
ET2	Non-Contact 2-Lead
ET2L	Non-Contact 2-Lead
E24	Contact 2-Lead
E24L	Contact 2-Lead
E25	Contact 2-Lead
E25L	Contact 2-Lead
S1	1 Sensor
S2	2 Sensors

Option	
Symbol	Name
F	With Absorber
L	Long Body
Z	Special Type (Custom)

\*Please refer to specification for applicable stroke

For sensor detail

▶ 277P

For option detail

▶ 36P

## Specification

Model	ZD(ZB)-25A	ZD(ZB)-32A	ZD(ZB)-40A	ZD(ZB)-50A
	For Layout Drawing ▶469P	For Layout Drawing ▶469P	For Layout Drawing ▶470P	For Layout Drawing ▶470P
Working Pressure	Pneumatic: 0.15 to 0.99MPa			
Lubrication	Not Required or Turbine Oil Class 1 (ISOVG32)			
Ambient Temperature (°C)	5 to 60			
Operating Piston Speed	50 to 1000mm/∑			
Cylinder Diameter (mm)	dia.25	dia.32	dia.40	dia.50
Rod Diameter (mm)	dia.10	dia.12	dia.16	dia.20
Theoretical Thrust (N)	Advance	490P	800P	1250P
	Return	410P	690P	1050P
Total Jaw Stroke (mm)	75•100•150•200•250•300			
	350•400•450•500	350•400•450•500•600	350•400•450•500•600•700•800	350•400•450•500•600•700•800•900•1000
Weight (kg)	ZB	3.00±0.004st	4.95±0.005st	9.67±0.008st
	ZD	3.06±0.004st	5.13±0.005st	10.10±0.008st

## Internal Structure / Parts & Seals

### ■ ZD

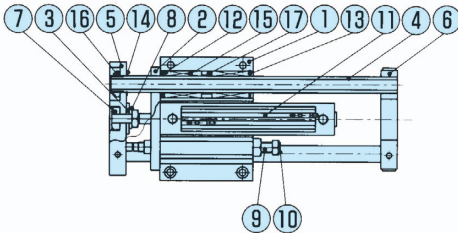

### ■ ZB

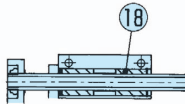

### ■ Parts List

No.	Name	Material	No.	Name	Material	No.	Name	Material
1	Body	Aluminum	8	Spring Washer	Carbon Steel	15	Bearing	
2	Front Cover	Steel Material	9	Stopper Bolt	Carbon Steel	16	Bearing Nut	
3	Washer A	Carbon Steel	10	Stopper Cushion	Urethane	17	Collar	Carbon Steel Pipe
4	Guide Rod	High-Carbon Chromium Bearing Steel	11	Cylinder		18	Bush	
5	Front Plate	Steel Material	12	Felt Seal		19	Bearing Collar	Carbon Steel Pipe
6	Back Plate	Steel Material	13	Snap Ring A		20	Felt Collar	Carbon Steel Pipe
7	Cylinder Joint	Carbon Steel	14	Snap Ring B				

# ZD(ZB) Series Long Stroke Slide

## Performance Data

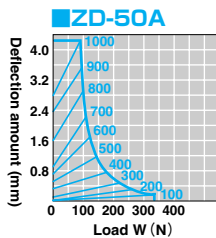
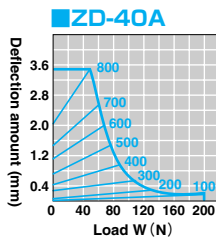
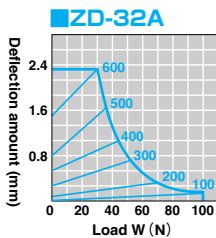
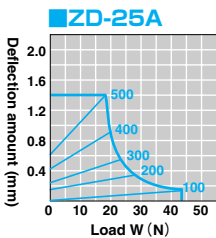
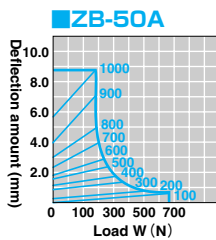
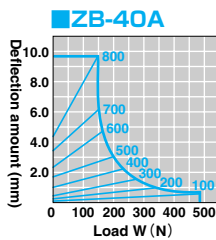
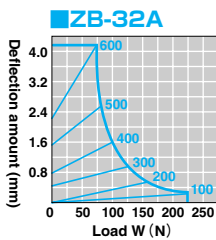
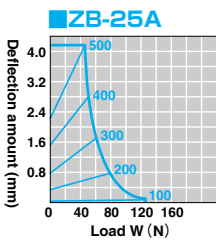
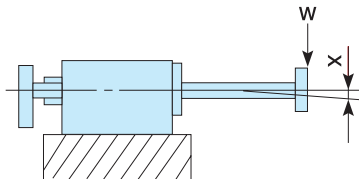

## ZD (ZB) Slot for Mounting

- A section slot can be used for connecting lead wires, nylon tubes, or mounting small objects such as terminal blocks to the body. (M4)
- B section slot can be used for mounting the body. Mounting position can be adjusted.

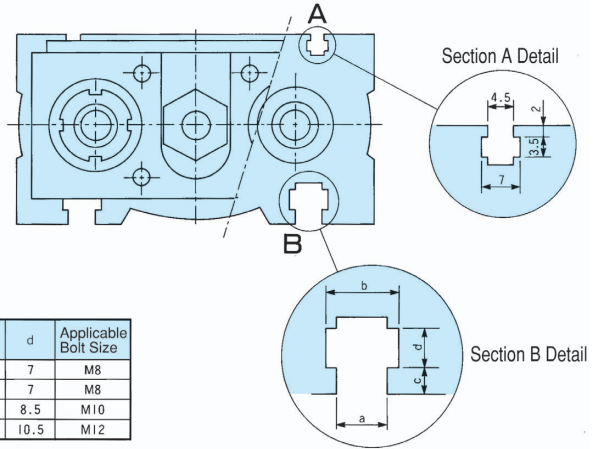

	a	b	c	d	Applicable Bolt Size
ZD(ZB)-25A	9	13	5	7	M8
ZD(ZB)-32A	9	13	5	7	M8
ZD(ZB)-40A	11	17	6	8.5	M10
ZD(ZB)-50A	13	19	7	10.5	M12

## ZD (ZB) Lift Eccentric Load

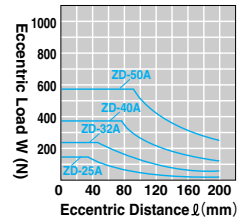
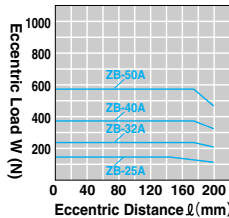
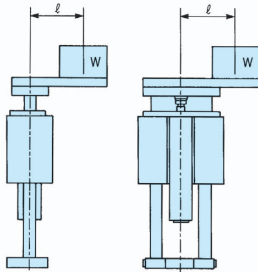

# ZD(ZB) Series Long Stroke Slide

## Layout Drawing

### ZD(ZB)-25A (Thrust 205N)

#### ZD(ZB)-25A Standard

\*Values inside ( ) are for long body.

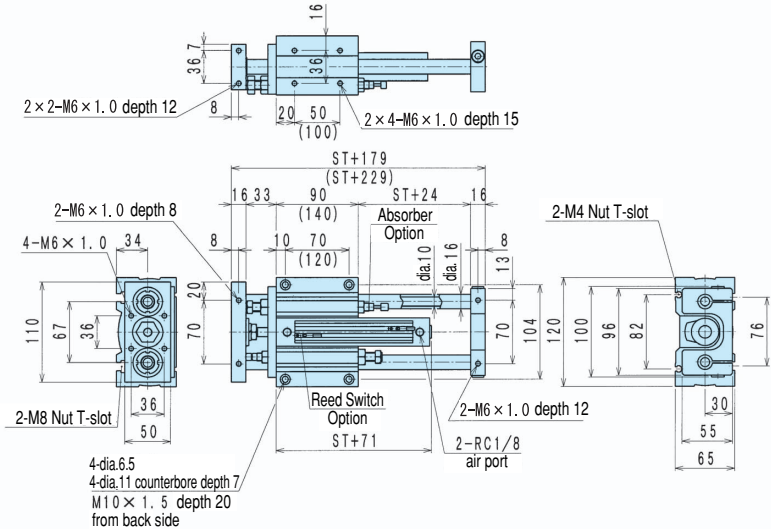

### ZD(ZB)-32A (Thrust 345N)

#### ZD(ZB)-32A Standard

\*Values inside ( ) are for long body.

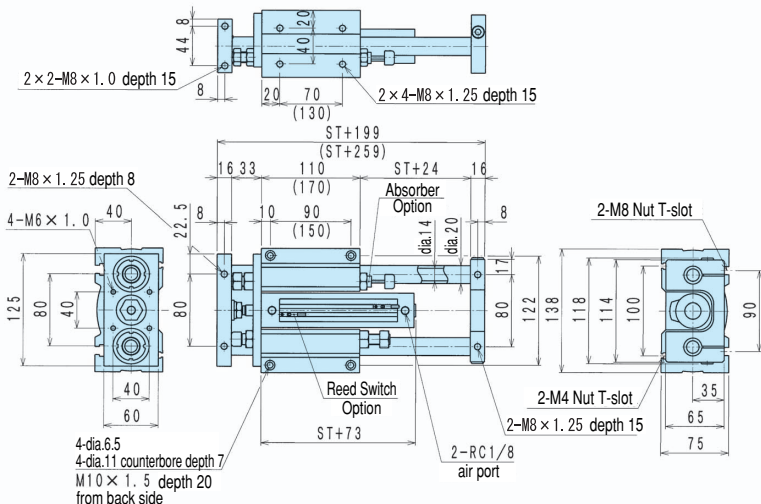

# ZD(ZB)-25A/32A/40A/50A

 For CAD data, please go to **▶518P**

## ZD(ZB)-40A (Thrust 525N)

### ZD(ZB)-40A Standard

\*Values inside ( ) are for long body.

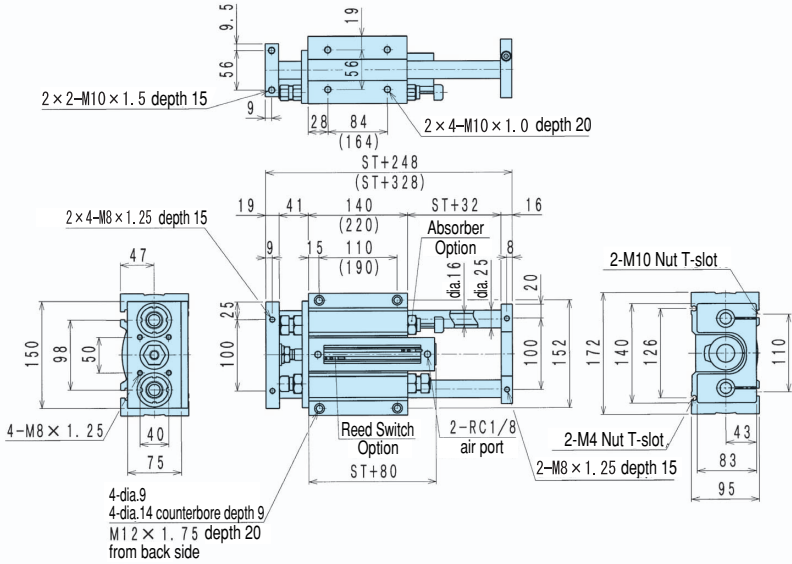

## ZD(ZB)-50A (Thrust 820N)

### ZD(ZB)-50A Standard

\*Values inside ( ) are for long body.

