

HH Series High Grip Force Hand

High Grip Force Light-Weight Parallel Hand

Key Features

Space-saving

Low profile body design for mounting the gripper in confined spaces

High grip force and light weight

Light weight for use with smaller payload robot

High rigidity and durability

T-slot jaw slide guide for higher impact resistance

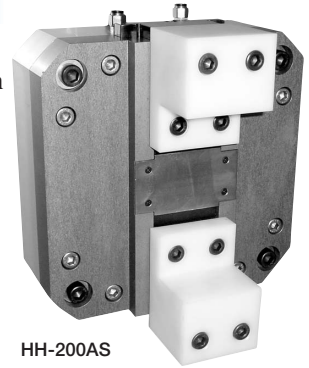

HH-200AS

Hand
(2-law)

How To Order

Standard ----- **HH-100AS**

Option ----- **HH - 100AS - ET3S2** ----- HH-100AS with 2 of ET3 non-contact reed switches

Size		Sensor, Quantity			
Symbol		Symbol	Name	Symbol	Name
100AS		ET3	Non-Contact 3-Lead	S2	2 Sensors
150AS		ET3L	Non-Contact 3-Lead		
200AS		ET2	Non-Contact 2-Lead		
		ET2L	Non-Contact 2-Lead		
		S1	1 Sensor		

For sensor detail ▶277P

Specification

Model	HH-100AS For Layout Drawing ▶145P	HH-150AS For Layout Drawing ▶145P	HH-200AS For Layout Drawing ▶146P
Working Pressure	Pneumatic: 0.3 to 0.7MPa		
Lubrication	Not Required or Turbine Oil Class 1 (ISOVG32)		
Ambient Temperature (°C)	5 to 60		
Total Jaw Stroke (mm)	12	16	20
Cylinder Diameter (mm)	dia.100	dia.150	dia.200
Rod Diameter (mm)	dia.20	dia.24	dia.34
Internal Volume [Reciprocation] (cm ³ /time)	227	837	1795
Repeatability (mm)	±0.01		
Weight (kg)	3.4	8.8	21

Internal Structure / Parts & Seals

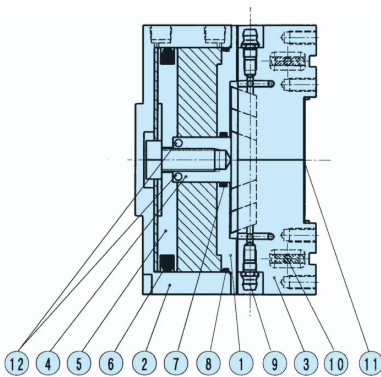

Parts List

No.	Name	Material	No.	Name	Material	No.	Name	Material
1	Body	Aluminum	5	Piston B	Stainless Steel	9	Grease Nipple	
2	Cylinder	Aluminum	6	Piston Seal		10	Magnet	
3	Master(Base) Jaw	Carbon Steel	7	Rod Seal 1		11	Center Cover	Stainless Steel
4	Piston A	Carbon Steel	8	Cylinder Seal		12	Rod Seal 2	

Seals List

No.	HH-100AS	HH-150AS	HH-200AS
6	PSD-100	PSD-150	PSD-200
7	MYA-20	MYA-24	MYA-34
8	S-95	G-145	G-190
12	S-12	S-16	S-24

Performance Data

Grip Force

The graph shows grip force in opening and closing with effective external finger lengths ℓ from gripper cover surface under different air pressure (MPa)

Open (⇐) ---
 Closed (⇒) —

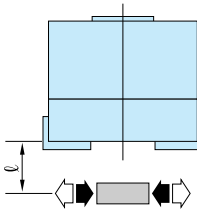

HH-100AS

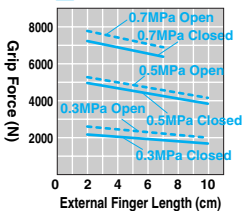

HH-150AS

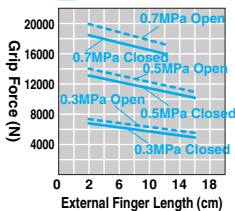

HH-200AS

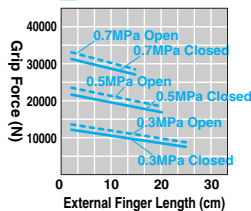

Layout Drawing

■ HH-100AS (Optimal Grip Force 2000N to 5000N)

HH-100AS Standard

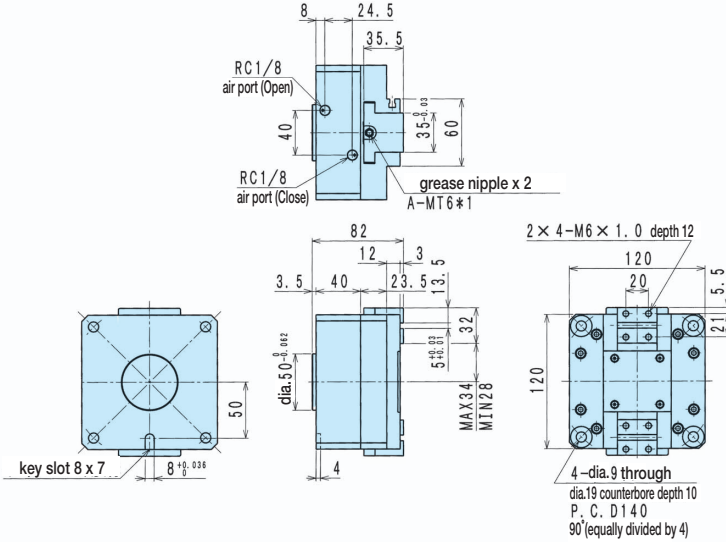

■ HH-150AS (Optimal Grip Force 5000N to 12000N)

HH-150AS Standard

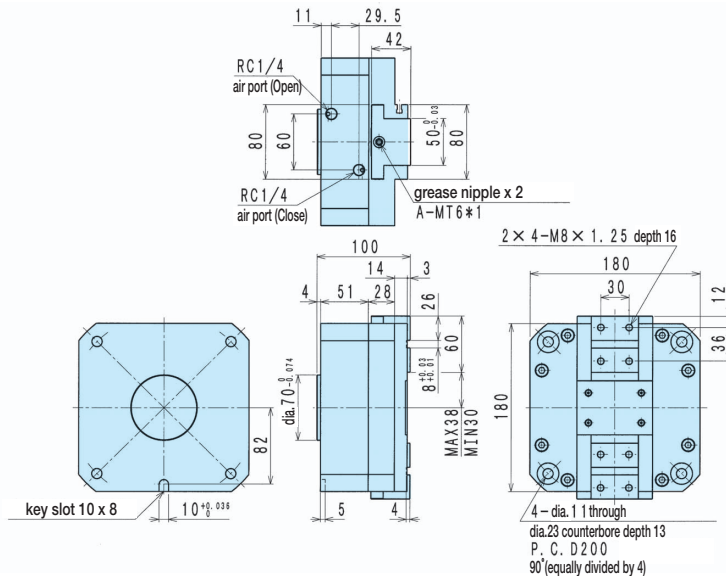

Hand (2-law)

HH-100AS/150AS/200AS

For CAD data, please go to **▶518P**

■HH-200AS (Optimal Grip Force 8000N to 22000N)

HH-200AS Standard

