

CKR Series Swivel Chuck

Powerful Chuck with Rotational Function

Key Features

- Integrated powerful compact chuck with rotation function
- Fixed pipings and wirings not affected by motion
- Timing pulley suitable for locating

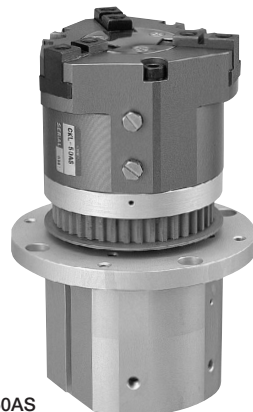

CKR-50AS

How To Order

Standard ----- **CKR-20AS**

Option ----- **CKR - 20AS - ET3S2 - Z** ----- CKR-20AS with 2 of ET3 non-contact reed switches and special processing.

Size	
Symbol	Name
20AS	63AS
25AS	
32AS	
40AS	
50AS	

Sensor, Quantity			
Symbol	Name	Symbol	Name
ET3	Non-Contact 3-Lead	E24L	Contact 2-Lead
ET3L	Non-Contact 3-Lead	E25	Contact 2-Lead
ET2	Non-Contact 2-Lead	E25L	Contact 2-Lead
ET2L	Non-Contact 2-Lead	S1	1 Sensor
E24	Contact 2-Lead	S2	2 Sensors

Option	
Symbol	Name
Z	Special Type (Custom)

For sensor detail ▶ 277P

For option detail ▶ 36P

Specification

Model	CKR-20AS For Layout Drawing ▶ 486P	CKR-25AS For Layout Drawing ▶ 486P	CKR-32AS For Layout Drawing ▶ 487P	CKR-40AS For Layout Drawing ▶ 487P	CKR-50AS For Layout Drawing ▶ 488P	CKR-63AS For Layout Drawing ▶ 488P
Working Pressure	Pneumatic: 0.3 to 0.7MPa					
Lubrication	Not Required or Turbine Oil Class 1 (ISOVG32)					
Ambient Temperature (°C)	5 to 60					
Allowable Rotation Speed (rpm)	max.100					
Swivel Angle	360°					
Total Jaw Stroke (mm)	5	6	8	10	12	16
Cylinder Diameter (mm)	dia.20	dia.25	dia.32	dia.40	dia.50	dia.63
Rod Diameter (mm)	dia.6	dia.8	dia.10	dia.12	dia.14	dia.16
Internal Volume [Reciprocation] (cm ³ /time)	1.8	3.3	7.7	15.6	28.3	60.3
Repeatability (mm)	±0.01					
Weight (kg)	0.75	0.82	0.87	1.47	1.65	2.08

CKR-20AS/25AS/32AS/40AS/50AS/63AS

Load Torque Reference Chart

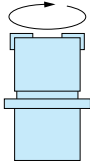

CKR-20·25·32AS

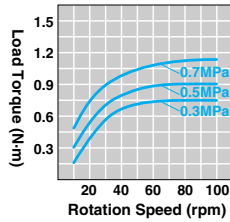

CKR-40·50·63AS

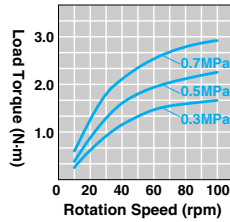

Internal Structure / Parts & Seals

CKR-20 · 25AS

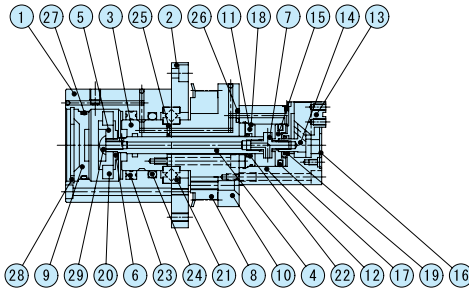

CKR-32 to 63AS

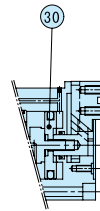

Parts List

No.	Name	Material	No.	Name	Material	No.	Name	Material
1	Mount Base	Aluminum	11	Gripper Cylinder Cover	Aluminum	21	Cross Roller Bearing	
2	Mount Flange	Aluminum	12	Body	Aluminum	22	Rod Seal	
3	Swivel Base	Aluminum	13	Master(Base) Jaw	Carbon Steel	23	X Ring	
4	Piston Pusher	Aluminum	14	Piston A	*	24	O-Ring	
5	Magnet Plate A	Aluminum	15	Piston B	Aluminum	25	O-Ring	
6	Magnet Plate B	Aluminum	16	Center Cover	Stainless Steel	26	O-Ring	
7	Piston Joint	Stainless Steel	17	Piston Seal		27	O-Ring	
8	Pulley	Carbon Steel	18	Cylinder Seal		28	C-Type Snap Ring	Stainless Steel
9	Cylinder Cover	Resin	19	Rod Seal		29	Small Truss Head Screw	Stainless Steel
10	Chuck Mounting Plate	Aluminum	20	Magnet		30	Piston C	Aluminum

*Stainless steel for 20AS to 32AS, and carbon steel for 40AS to 63AS

Seals List

No.	CKR-20AS	CKR-25AS	CKR-32AS	CKR-40AS	CKR-50AS	CKR-63AS
17	PSD-20	PSD-25	PSD-32	PSD-40	PSD-50	PSD-63
18	dia.18×dia.1	dia.22.33×dia.1.02	S-29	S-36	S-48	S-60
19	MYA-6	MYA-8	MYA-10	MYA-12	MYA-14	MYA-16
22	MYA-8	MYA-8	MYA-8	MYA-10	MYA-10	MYA-10
23	KX-24	KX-24	KX-24	KX-32	KX-32	KX-32
24	P-24	P-24	P-24	P-32	P-32	P-32
25	S-3	S-3	S-3	S-3	S-3	S-3
26	P-3	P-3	P-3	P-3	P-3	P-3
27	S-29	S-29	S-29	S-36	S-36	S-36

Performance Data

■ Grip Force

The graph shows grip force in opening and closing with effective external finger lengths l from gripper cover surface under different air pressure (MPa)

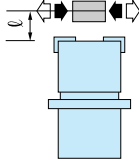

Open (⇐) ————
 Closed (⇒) —————

■ CKR-20AS

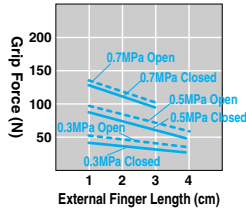

■ CKR-25AS

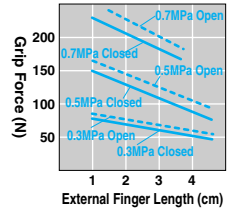

■ CKR-32AS

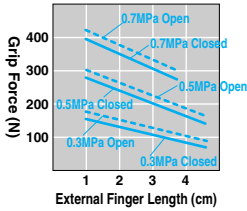

■ CKR-40AS

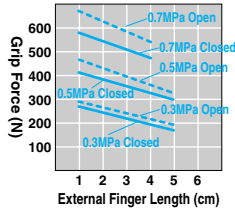

■ CKR-50AS

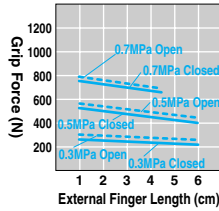

■ CKR-63AS

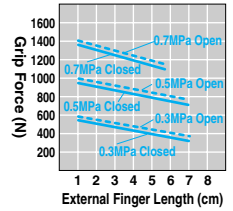

CKR-20AS/25AS/32AS/40AS/50AS/63AS

Layout Drawing

For CAD data, please go to **▶518P**

CKR-20AS (Optimal Grip Force 60N to 100N)

CKR-20AS Standard

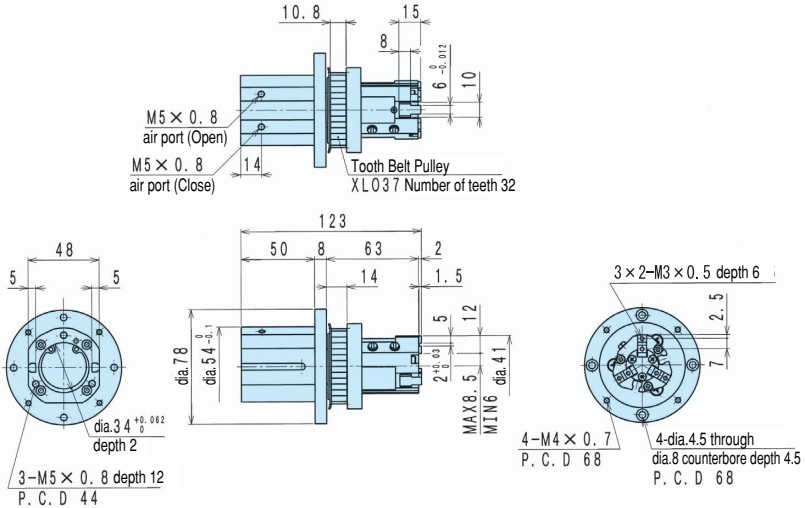

CKR-25AS (Optimal Grip Force 80N to 180N)

CKR-25AS Standard

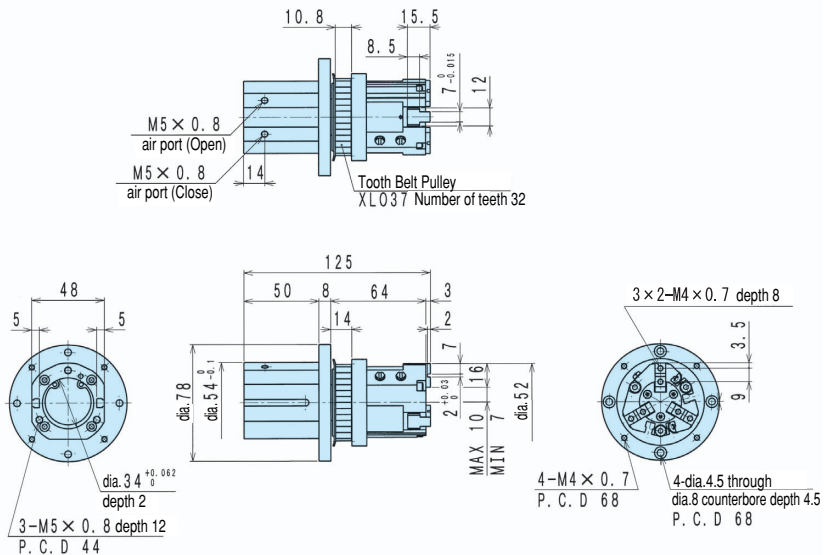

Robotic Peripheral
Devices

CKR Series Swivel Chuck

Layout Drawing

CKR-32AS (Optimal Grip Force 150N to 300N)

CKR-32AS Standard

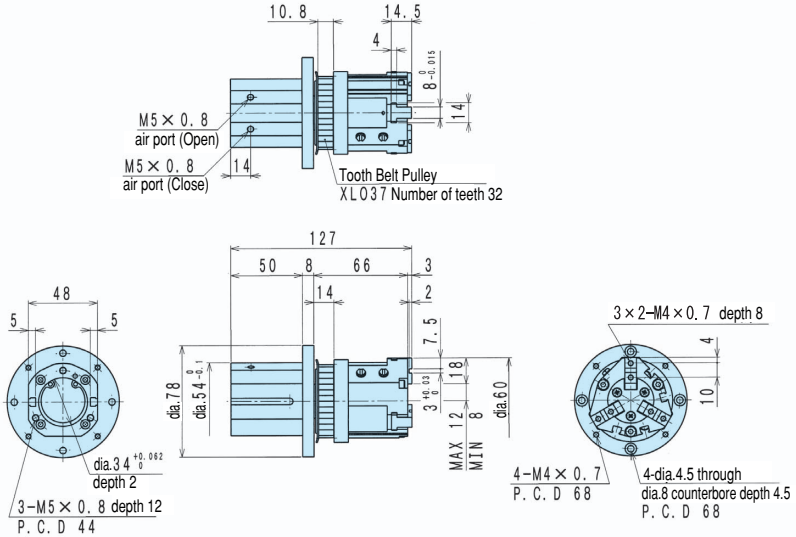

CKR-40AS (Optimal Grip Force 200N to 450N)

CKR-40AS Standard

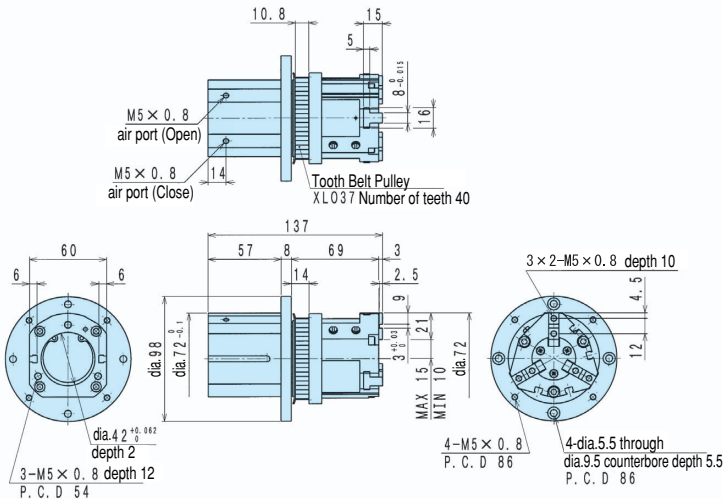

CKR-20AS/25AS/32AS/40AS/50AS/63AS

For CAD data, please go to **▶518P**

■CKR-50AS (Optimal Grip Force 450N to 650N)

CKR-50AS Standard

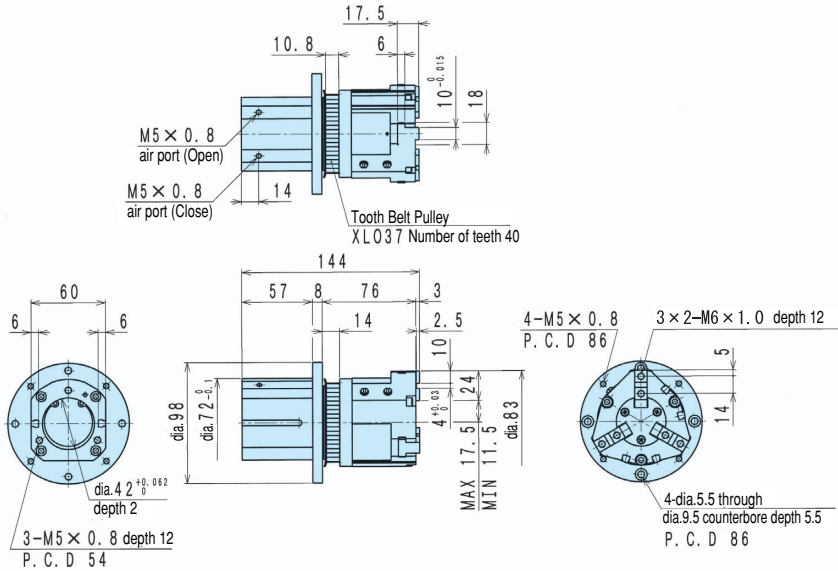

■CKR-63AS (Optimal Grip Force 600N to 1000N)

CKR-63AS Standard

