

# Transfer type LTU-□□□CE

Non-contact conveying



## ● Original design

Myotoku's air technology actualizes high precision levitating

## ● Stable levitation

Stable levitation for exposure or inspection process

## How to order

LTU - 100 CE

Length

050	500mm
075	750mm
100	1000mm

## Specifications

Reference	Unit	LTU-□□□CE
Size(W × L × H)	mm <inch>	100 × 500 × 45.8 <3.94 × 19.69 × 1.80>
		100 × 750 × 45.8 <3.94 × 29.53 × 1.80>
		100 × 1000 × 45.8 <3.94 × 39.37 × 1.80>
Fluid		Non-corrosive / Non-inflammable gas *1
Ambient temperature	°C	23 ± 10
Lubrication		unavailable
Operating pressure range	kPa	30 ~ 400
Flatness	μm	60 (at 23°C)
Parallelism	μm	80 (at 23°C)

\*1 Supply compressed air using air filter with filtration rate lower than 5 μm and oil mist separator with 0.01 μm filtration rate.

## Dimensions

Unit : mm <inch>

LTU-□CE

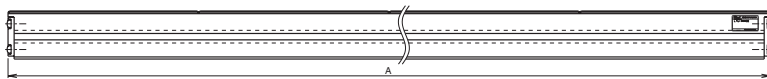
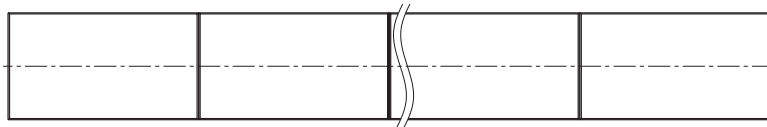
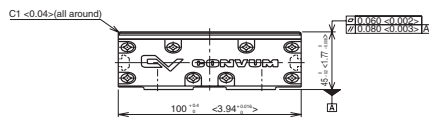

	A	B
LTU-050CE	500 <19.69>	300 <11.81>
LTU-075CE	750 <29.53>	550 <21.65>
LTU-100CE	1000 <39.37>	800 <31.50>

